

TAKE A GANDER

AT THE BIGGEST OUTDOOR FARM SHOW IN CANADA

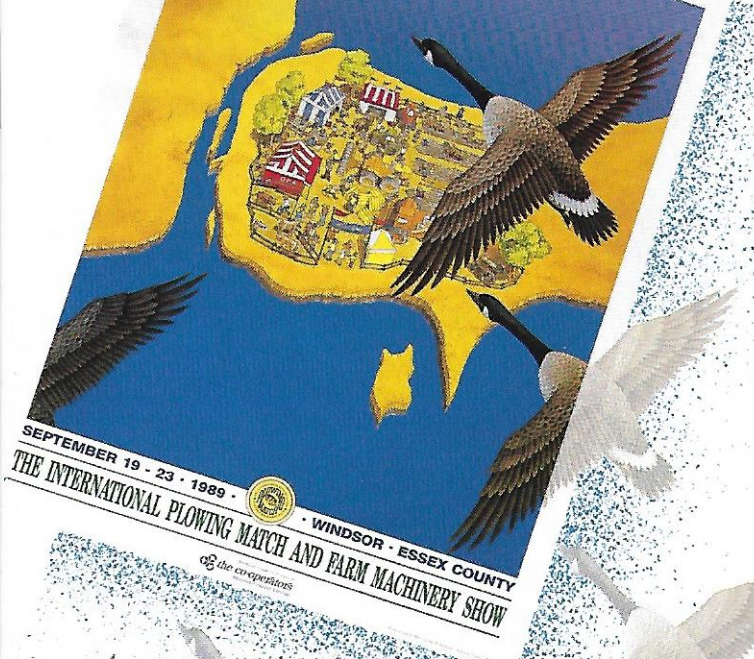

P R O G R A M

SEPTEMBER 19 - 23 • 1989 • WINDSOR • ESSEX COUNTY

If you're looking for ways to save, look for us.

We're delighted to be back at the IPM again this year. And we've brought with us a whole bunch of money saving ideas.

Come in to see us and we'll be happy to talk with you about ways you can save energy and money on lighting, heating, ventilation and much more.

We've got information on everything from heat pumps to infra red heat lamps to fluorescent lighting and other energy efficient equipment.

An energy saving R2000 home will also be on display in the "tented city."

Come on in to our tent at Headquarters Ave. and Fifth St. We're here to listen.

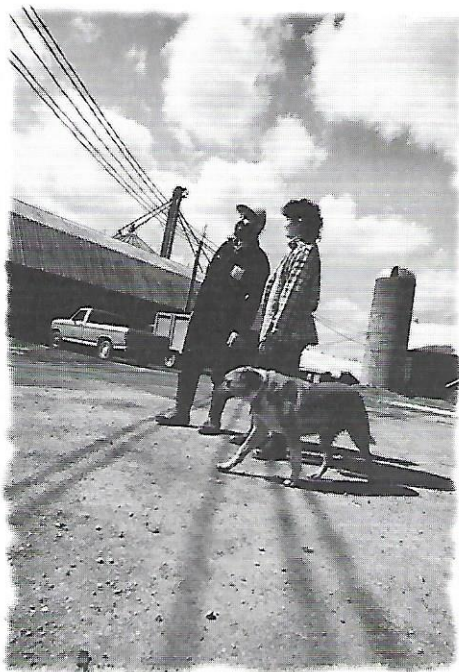

1-800-263-9000

Ontario Hydro

Ces services sont également offerts en français.

Saturday, August 12th

- Carroll Baker Concert
Belle River Arena
2 shows : 2:00 p.m. — 3:30 p.m.
8:00 p.m. — 9:30 p.m.
Dance to follow 9:30 p.m. with
The Carroll Baker Band

Tickets: Afternoon — \$6.00 for seniors
— \$8.00 for general
Night — \$8.00 for stands
— \$10.00 for floor
Refreshments available at the
evening performance.

Sunday, September 17th

- 7:30 p.m. Ecumenical Church Service
United Mennonite Educational
Institute Auditorium, Blytheswood,
Ontario
Guest Speaker: Reverend John
Mooney of Port Burwell, author
of the Roman Catholic Bishops'
Statement on Agriculture

Match Site

- The site of the 1989 International Plowing Match and Farm Machinery Show was selected in 1986. Detailed plans for exhibitor space, display areas and plowing fields took three years to complete. Nearly 800 acres of land will be used at the Match to provide parking, display space and competition fields.
- The Match is easy to find. It's located 8 miles east of the City of Windsor. If you are coming from the east, follow Highway #401 and take the Belle River/Puce Exit. If you are travelling from the United States, take I-75 to the tunnel or bridge and follow the signs to the parking areas located on the western, eastern and southern boundaries of the site.

Parking and Traffic

- Approximately 300 acres of land have been set aside for free parking for the 10,000 cars expected on the Match site each day. With an anticipated attendance of over 100,000 people, traffic control is a major challenge. The Ontario Provincial Police and the local organizing committee have posted direction signs on all routes to the site.

Admission Charges

- Adults and young people 14 years and over — \$6.00
Children under 14 — \$2.00

Bands and Parades

- Tuesday's Opening Day Parade, beginning at Bridgen Square at 1:15 p.m., kicks off a week filled with excitement. At Saturday's Closing Day Parade, we salute Brant County, host of the 1990 International Plowing Match and Farm Machinery Show.

Our Mascot

- Be sure to visit "Jenny" at the Match. She is the 1989 International Plowing Match and Farm Machinery Show's official mascot. Jenny is a six-year old, 2,000 pound Belgian draft horse.

Tented City

- This self-contained community exists for a week every year and then disappears. It has its own police force, fire department, garbage collection, water, hydro, telephone system, food and beverage outlets and all other conveniences of a modern community. The city is open from 9:00 a.m. to 6:00 p.m. daily, Saturday 9:00 a.m. to 5:00 p.m..

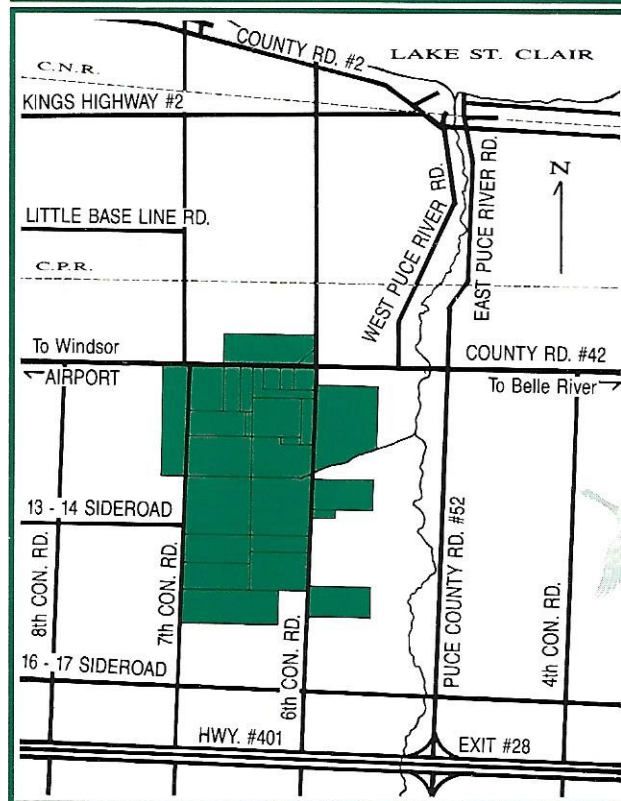
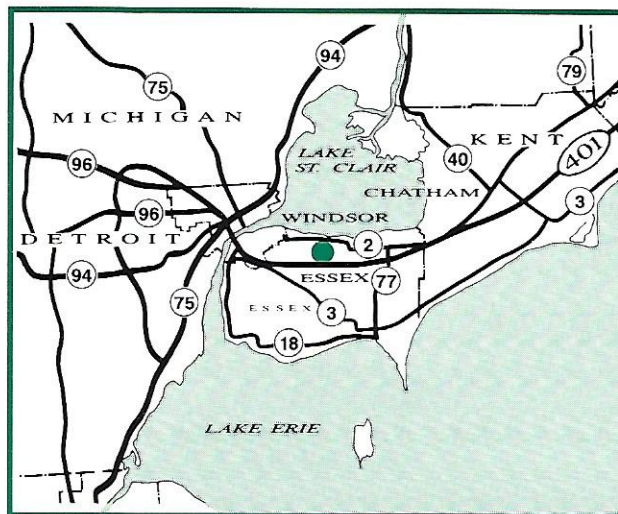

For further information:

- | | |
|--|---|
| <ul style="list-style-type: none">General Manager
Ontario
Plowmen's
Association
Guelph
Agriculture
Centre
52 Royal Road
Guelph, Ontario
(519) 767-3641 | <ul style="list-style-type: none">Secretary
Essex County
Local Committee
OMAF
46 Fox Street
Essex, Ontario
N8M 2S2
(519) 776-7361 |
|--|---|

Opening Day

9:00 a.m.	Exhibits open to the public
9:30 a.m.-5:00 p.m.	Family Focus features food, fashions, flowers, fancywork, facts & fun
10:00 a.m.	Plowing competition begins
10:00 a.m.-10:45 a.m.	Horseshoeing demonstration, Special Events Area
10:00 a.m.-12:00 p.m.	Motif painting near headquarters
10:00 a.m.-4:00 p.m.	Border City Cloggers at regular intervals at Bridgen Square
10:00 a.m.-4:00 p.m.	Demonstrations at Antique Display
11:45 a.m.	Ontario Plowmen's Association Luncheon (by invitation)
1:15 p.m.	Official Opening Day Parade
2:00 p.m.	Official Opening Ceremony at Bridgen Square by The Honourable Paul Martin Sr. In attendance: Honourable David Peterson Premier of Ontario Honourable Jack Riddell Ontario Minister of Agriculture & Food Honourable Don Mazankowski Deputy Prime Minister and Minister of Agriculture for Canada Governor James Blanchard, Governor of Michigan
2:00 p.m.-4:00 p.m.	Motif painting near headquarters
2:30 p.m.	M.P.'s & M.P.P.'s Plowing Competition Special Events Area
3:00 p.m.-3:45 p.m.	Horseshoeing demonstration, Special Events Area
6:00 p.m.	Exhibits closed to the public

Plowing Program

- There will be plowing competitions daily at 10:00 a.m. featuring horses and every kind of tractor, from the antique models to the most modern machines in use today.

Essex County Day

9:00 a.m.	Exhibits open to the public
9:30 a.m.-5:00 p.m.	Family Focus features food, fashions, flowers, fancywork, facts & fun
9:30 a.m.-8:30 p.m.	County Tours at scheduled times
10:00 a.m.	Plowing competition begins
10:00 a.m.-12:00 p.m.	Motif painting near headquarters
10:00 a.m.-4:00 p.m.	Square Dancing by Gingham Swing 'Ems at Bridgen Square
10:00 a.m.-4:00 p.m.	Demonstrations at Antique Display
10:30 a.m.	Media Plowing Competition, Special Events Area
12:30 p.m.	Conservation Tillage Competition begins
1:00 p.m.-1:30 p.m.	Grape Stomping with ethnic groups and politicians, near headquarters
2:00 p.m.	Queen of the Furrow Plowing Competition Special Events Area
2:00 p.m.-4:00 p.m.	Motif painting near headquarters
6:00 p.m.	Exhibits closed to the public

Special Events Area

- The Special Events Area is the site for special plowing events. You can watch the Queen of the Furrow plowing competition or see the politicians, mayors, reeves, wardens, media and the Junior Farmers try their hand at plowing.
- Massey-Ferguson International Media Challenge Competition: Media personalities from both sides of the border test their plowing skills. Last held in 1969, the international tradition continues.

.....

Essex County Exhibit

- The 1989 Essex County Host Committee invites everyone to "Take a Gander" at our exhibit. With five tents in all, this will be the largest county exhibit in the history of the show.
- A first at the County Exhibit will be the Industrial Tent, which will highlight the broad range of industry in our area. We have food processing, plastics, robotics, engineering, fishing, automotive parts and manufacturing companies represented.
- The Municipalities and Associations Tent will bring together twenty municipalities plus Pelee Island, Canada's southernmost township. The County of Essex and local groups and organizations are pleased to give you an overall view of our county.
- "Jenny," a Belgian mare, is the Essex County IPM mascot and will be one of the attractions in the Agricultural Tent. Along with Jenny we have three breeds of heavy horses as well as swine, sheep, poultry, beef and dairy cattle. Greenhouse produce, vegetables, fruit, honey, mushrooms, flowers, grains and farm organizations round out the agricultural display.
- Education and health play an important role in our lives. Our schools and health organizations have provided us with examples that demonstrate our excellence in these fields. A visit to the Education & Health Tent will be time well spent.
- Last but not least, the City of Windsor is an integral part of Essex County. The city will be showcased in its own tent, with a variety of exhibits ranging from tourist attractions to the University of Windsor. The "City of Roses" welcomes you!
- For rest and relaxation, sit down on the picnic tables provided for you in the courtyard and gaze at the beautifully landscaped area.

- Our many volunteers hope you will enjoy the numerous displays and exhibits we have arranged for you. Take your time, relax and come see what Essex County has to offer.

.....

Special Events

- For the first time at an international level, the 1989 International Plowing Match will include a Conservation Tillage Competition. The competition will take place Wednesday, September 20th, and is being sponsored by the Essex County Soil & Crop Improvement Association, the Ontario Ministry of Agriculture and Food and the Essex Region Conservation Authority.
- Each day of the Match, we will have a main attraction, which will feature such things as a Horse Show, a professional Grape Stomp, a Horseshoeing Demonstration, a Mini-Tractor Pull and the Horseshoe Pitching Tournament. Watch for the signs indicating times and locations for each event.
- There will be a variety of entertainment at Bridgen Square throughout the week. Some of the special attractions will be: The Border City Cloggers, Sweet Adelines as well as a magician and banjo players. There will also be motif painting, clowns, Boblo Island animal characters, and of course a Scottish bag piper.

.....

Wagon Tours

- Tractor-drawn wagons will provide free shuttle service between Tented City, the competition sites and parking areas. The tractors are provided courtesy of Essex County Farm Dealers and Essex County farmers. The wagons are also provided courtesy of Essex County farmers. The fuel has been graciously provided by McKee Fuels, Division of Comtrade Petroleums Inc., Windsor.

Queen of the Furrow Day

9:00 a.m.	Exhibits open to the public
9:30 a.m.-4:00 p.m.	County Tours at scheduled times
9:30 a.m.-5:00 p.m.	Family Focus features food, fashions, flowers, fancywork, facts & fun
10:00 a.m.	Plowing competition begins
10:00 a.m.-10:45 a.m.	Horseshoeing demonstration, Special Events Area
10:00 a.m.-12:00 p.m.	Motif painting near headquarters
10:00 a.m.-4:00 p.m.	Sweet Adelines at regular intervals at Bridgen Square
10:00 a.m.-4:00 p.m.	Demonstrations at Antique Display
1:30 p.m.	Speeches by Queen of the Furrow contestants at Bridgen Square
2:00 p.m.	Junior Farmer Plowing Competition, Special Events Area
2:00 p.m.-4:00 p.m.	Motif painting near headquarters
3:00 p.m.-3:45 p.m.	Horseshoeing demonstrations, Special Events Area
6:00 p.m.	Exhibits closed to the public
6:30 p.m.-9:00 p.m.	Queen of the Furrow Crowning Banquet Fogolar Furlan Club, Windsor
9:00 p.m.-1:00 a.m.	Plowmen's Ball Fogolar Furlan Club, Windsor

Queen of the Furrow

- Thirty-eight young ladies representing counties and regions across Ontario will vie for the title of 1989-90 Queen Of The Furrow. The contestants will be judged on their decorum, poise, plowing skills and their ability to communicate with the public. A special display case with pictures of all contestants and gifts donated for the competition will be exhibited near headquarters.

- The contestants will be honoured at the Queen of the Furrow Crowning Banquet, Thursday, September 21st at 6:30 p.m. at the Fogolar Furlan Club in Windsor.

Plowmen's Ball

- On Thursday, September 21st, the Essex County Junior Farmers Plowmen's Ball will be held at the Fogolar Furlan Club, Windsor.
Time: 9:00 p.m. to 1:00 a.m.
Music: by "Nemesis"

Antique and Historical Display

- Breaking New Ground/Building a Life**
There will be displays of early farm machinery and tractors as well as working displays at regular intervals.
- Visitors will be able to view various activities either machine or man operated. Among the various displays there will be small engines, farm implements and inside the Antique and Historical Tent there will be various artifacts of historical significance.

Souvenirs

- Be part of the International Plowing Match and Farm Machinery Show by purchasing a souvenir from Essex County.
- The 1989 Official Souvenirs are available throughout the Match. Souvenirs include: cookbooks, baseball caps; ladies caps; gatsbys; children's "Jenny" caps; "Jenny" sun visors; coffee mugs; "Jenny" plastic tumblers; spoons; sweatshirts; golf shirts; T-shirts; pins; posters; spring jackets; toy tractors; toy walking plows.
- For further information, call Bonnie Popov (519) 723-2230, Katie Starzacher (519) 727-6533 or Dianne Colantonio (519) 727-6409. For T-shirts contact Marion Bennet (519) 255-9575.

S E P T E M B E R

S E P T E M B E R

Awards Day

9:00 a.m.	Exhibits open to the public
9:30 a.m.-4:00 p.m.	County Tours at scheduled times
9:30 a.m.-5:00 p.m.	Family Focus features food, fashions, flowers, fancywork, facts & fun
10:00 a.m.	Plowing competition begins
10:00 a.m.-12:00 p.m.	Motif painting near headquarters
10:00 a.m.-4:00 p.m.	Magician James Ryckman at regular intervals in Bridgen Square
10:00 a.m.-4:00 p.m.	Demonstrations at Antique Display
2:00 p.m.	Warden Plowing Competition, Special Events Area
2:00 p.m.-4:00 p.m.	Motif painting near headquarters
6:00 p.m.	Exhibits closed to the public
7:00 p.m.	Plowmen's Awards Banquet, Cleary Auditorium, Windsor (by invitation)

Awards Banquet

- The Plowmen's Awards Banquet on Friday, September 22 at Windsor's Cleary Auditorium overlooking the Detroit skyline, will be the highlight of the week for all plowing contestants. Prizes will be presented to the winners of each plowing class after dinner. The new 1989-90 Queen Of The Furrow will be introduced.

Tractor Park

- Competitors can safely store their equipment in the tractor park, an area closed to the public and under 24-hour security. Fuel, lubricants and repair equipment are also available here. Fuel for the plowmen has been provided by McKee Fuels, Division of Comtrade Petroleums Inc., Windsor.

Family Day

9:00 a.m.	Exhibits open to the public
9:00 a.m.	Horseshoe Pitching Match adjacent to Tented City
9:00 a.m.-12:30 p.m.	Horse Show Special Events Area
9:30 a.m.-5:00 p.m.	Family Focus features food, fashions, flowers, fancywork, facts & fun
10:00 a.m.-4:00 p.m.	Demonstrations at Antique Display
10:00 a.m.-12:00 p.m.	Motif painting near headquarters
10:00 a.m.-4:00 p.m.	Windsor Banjo at regular intervals in Bridgen Square
1:15 p.m.	Closing Day Parade & Salute to Brant County
1:30 p.m.-5:00 p.m.	Mini-Tractor Pull, Special Events Area
2:00 p.m.	Mayors & Reeves Plowing Competition, Special Events Area
2:00 p.m.-4:00 p.m.	Motif painting near headquarters
5:00 p.m.	Match site officially closed to the public

Flying Farmers

- The Flying Farmers airstrip will be on the farm of Richard Lefave. Location: 42° — 17' North, 82° 40' West, 2 miles east of Belle River, Ontario and 1/8 mile South of Lake St. Clair, elevation 585 feet, runway 01 — 19 2400 x 80 turf.
- Services: Emergency fuel only, 100 octane Oil 100/80
Phillips Multi Grade
- Communications: Unicom 122.8

Note: Those who wish to fly into the Windsor Airport are to taxi to South West Air. Transportation is provided to and from the match site from South West Air. Unicom 122.95.

Inquiries may be directed to Shari Karns or Gord Reid at South West Air (519) 966-5727.

Trailer Park

- Come and enjoy the excellent camping facilities at our Trailer Park, located beside the Tented City southern boundary fence. Serviced lots (hydro and water) cost \$75.00 and non-serviced lots cost \$60.00 for the entire week. Essex County talent will perform nightly at the entertainment tent, weather permitting. Tell your camping friends about this convenient and inexpensive IPM '89 accommodation feature. For information contact Edmund & Donna Mae Curtis, R.R. #1, Oldcastle, Ontario, N0R 1L0 (519) 969-7729.

Billeting

- Visitors can billet at private homes during the Match. Information on billeting arrangements is available prior to the Match by calling or writing Marilyn Rogers, R.R. #1, Kingsville, Ontario, N9Y 2E4 (519) 733-5209.

Where to Eat

- There is no excuse for anyone to go hungry during their visit to the Match. Refreshments are on hand to suit every taste and every budget. Quick snacks and full course meals prepared by church organizations, service clubs and farm commodity groups will be available in the Tented City.

County Tours

- Sneak a peak at Essex County and let someone else drive! Bus tours have been arranged commencing Wednesday and winding up on Friday. The following is a list of schedules:

Wednesday September 20

- 9:30 a.m.-4:00 p.m. "A Peak at Essex County" — bus tour of county with three stops. Cost: \$10.00 plus lunch.
- 9:30 a.m.-4:00 p.m. "Essex's Unique Crops" — bus tour with stops at greenhouses, tomato farm and processing plant. Cost: \$17.75 including lunch
- 5:30 p.m.-8:30 p.m. "Cruising the County" — driving tour of Essex County with agricultural commentary. Cost: \$10.00 plus dinner

Thursday September 21

- 9:30 a.m.-4:00 p.m. "A Peak at Essex County" — bus tour of county with three stops. Cost: \$10.00 plus lunch.
- 9:30 a.m.-4:00 p.m. "Featuring Farming" — tour of grain terminal and soybean crushing plant as well as Cornacre Farm (dairy farm) and Ewedell Farm (sheep). Cost: \$10.00 plus lunch.

Friday September 22

- 9:30 a.m.-4:00 p.m. "A Peak at Essex County" — bus tour of county with three stops. Cost: \$10.00 plus lunch
- 9:30 a.m.-4:00 p.m. "Essex's Unique Crops" — bus tour with stops at greenhouses, tomato farm and processing plant. Cost: \$17.75 including lunch
- 1:00 p.m.-4:00 p.m. "Cruising the County" — driving tour of Essex County with agricultural commentary. Cost: \$10.00

Family Focus

- "Family Focus" features something for everyone! We have food demonstrations by professional chefs, international cuisine presented by local cultural groups, fashion shows by local stores and boutiques, artwork and crafts by area artisans, as well as educational facts and entertainment. Come and "Take a Gander" at what we have to offer in Essex County. Schedules are as follows:

- Food Exhibit

Tuesday

- 9:30 a.m. Opening & Welcome
9:45 a.m. Egg Demonstration, Ellen Badeski
10:15 a.m. Facts & Fun
10:30 a.m. Mushroom Demonstration, Marilyn Hurley
11:00 a.m. Facts & Fun
11:15 a.m. Lebanese Cuisine
11:45 a.m. Facts & Fun
12:00 p.m. Entertainment
1:00 p.m. Chef Drago Kalabric, York Downs Golf & Country Club
1:45 p.m. Facts & Fun
2:00 p.m. Chicken Demonstration, Linda Glendenning
2:30 p.m. Facts & Fun
3:00 p.m. Chef Drago
3:30 p.m. Facts & Fun
3:45 p.m. "What's New at School", Local Food Service School Demonstration
4:15 p.m. Facts & Fun
4:30 p.m. Beef Demonstration, Mary Ann Yaromich
5:00 p.m. Closing draws

Wednesday

- 9:30 a.m. Opening & Welcome
9:45 a.m. Egg Demonstration, Ellen Badeski
10:15 a.m. Facts & Fun
10:30 a.m. Beef Demonstration, Mary Ann Yaromich
11:00 a.m. Facts & Fun
11:15 a.m. International Cuisine
11:45 a.m. Facts & Fun
12:00 p.m. Entertainment
1:00 p.m. Chef Ron Hart, Holiday Inn, Windsor
1:45 p.m. Facts & Fun
2:00 p.m. Milk Demonstration, Marilyn Hurley
2:30 p.m. Facts & Fun
3:00 p.m. Chef Ron Hart

Wednesday (continued)

- 3:30 p.m. Facts & Fun
3:45 p.m. Turkey Demonstration, Donna Marie Pye
4:15 p.m. Facts & Fun
4:30 p.m. "What's New at School", Local Food Service School Demonstration
5:00 p.m. Closing draws

Thursday

- 9:30 a.m. Opening & Welcome
9:45 a.m. Dairy Demonstrations, Marilyn Hurley
10:15 a.m. Facts & Fun
10:30 a.m. Chicken Demonstrations, "Alsop"
11:00 a.m. Facts & Fun
11:15 a.m. French-Canadian Cuisine
11:45 a.m. Facts & Fun
12:00 p.m. Entertainment
1:00 p.m. Chef Volker Jendhoff, Radison Hotels, London
1:45 p.m. Facts & Fun
2:00 p.m. Turkey Demonstrations, Donna Marie Pye
2:30 p.m. Facts & Fun
3:00 p.m. Chef Volker Jendhoff
3:30 p.m. Facts & Fun
3:45 p.m. Fish Demonstration
4:15 p.m. Facts & Fun
4:30 p.m. "What's New at School", Local Food Service School Demonstration
5:00 p.m. Closing draws

Friday

- 9:30 a.m. Opening & Welcome
9:45 a.m. Pork Demonstration, Thora Dolan
10:15 a.m. Facts & Fun
10:30 a.m. Dairy Demonstration, Marilyn Hurley
11:00 a.m. Facts & Fun
11:15 a.m. Historical Site Soul Cuisine
11:45 a.m. Facts & Fun
12:00 p.m. Entertainment
1:00 p.m. Chef Bob Long, Shawnee Secondary School, Windsor
1:45 p.m. Facts & Fun
2:00 p.m. Chicken Demonstration, Linda Glendenning
2:30 p.m. Facts & Fun
3:00 p.m. Chef Bob Long
3:30 p.m. Facts & Fun
3:45 p.m. Dairy Demonstration, Marilyn Hurley
4:15 p.m. Facts & Fun
4:30 p.m. "What's New at School", Local Food Service School Demonstration
5:00 p.m. Closing draws

.....

Saturday

- 9:30 a.m. Opening & Welcome
9:45 a.m. Pork Demonstration, Thora Dolan
10:15 a.m. Facts & Fun
10:30 a.m. Mushroom Demonstration,
Marilyn Hurley
11:00 a.m. Facts & Fun
11:15 a.m. Chinese Cuisine
11:45 a.m. Facts & Fun
12:00 p.m. Entertainment
1:00 p.m. Chef Rainer Schindler,
St. Clair College, Windsor
1:45 p.m. Facts & Fun
2:00 p.m. Chicken Demonstration,
Linda Glendenning
2:30 p.m. Facts & Fun
3:00 p.m. Chef Rainer Schindler
3:30 p.m. Facts & Fun
3:45 p.m. Fish Demonstration
4:15 p.m. Facts & Fun
4:30 p.m. "What's New at School", Local
Food Service School Demonstration
5:00 p.m. Closing draws

■ Fashion

Tuesday

- 9:45 a.m. Opening & Welcome
10:00 a.m. Fashions Along the North Shore
11:00 a.m. Facts & Fun
11:30 a.m. Colour, Fashions & You
12:00 p.m. Entertainment
1:00 p.m. Tops & Trends
1:30 p.m. Facts & Fun
2:00 p.m. Fashions Along the North Shore
3:00 p.m. Facts & Fun
4:00 p.m. Colour, Fashions and You
4:30 p.m. Crafty Creations
5:00 p.m. Closing draws

.....

Wednesday

- 9:45 a.m. Opening & Welcome
10:00 a.m. Fashions from Leamington
11:00 a.m. Facts & Fun
11:30 a.m. Sew Your Own Clothes
12:00 p.m. Entertainment
1:00 p.m. Tops & Trends
1:30 p.m. Entertainment
2:00 p.m. Fashions from Leamington
3:00 p.m. Facts & Fun
4:00 p.m. Sew Your Own Clothes
4:30 p.m. Facts & Fun
5:00 p.m. Closing draws

.....

Thursday

- 9:45 a.m. Opening & Welcome
10:00 a.m. Fashions from the "Hub" of the
County
11:00 a.m. Facts & Fun
11:30 a.m. Sew Your Own Clothes
12:00 p.m. Entertainment
1:00 p.m. Knit Your Own Woolens
1:30 p.m. Facts & Fun
2:00 p.m. Fashions from the "Hub" of the
County
3:00 p.m. Facts & Fun
4:00 p.m. Colours with Tops & Trends
4:30 p.m. Sew & Sew
5:00 p.m. Closing draws

.....

Friday

- 9:45 a.m. Opening & Welcome
10:00 a.m. Fashions Along the South Shore
11:00 a.m. Facts & Fun
11:30 a.m. Canadian Fashion Designer —
Leather & Suedes
12:00 p.m. Entertainment
1:00 p.m. Colours & Fashions
1:30 p.m. Facts & Fun
2:00 p.m. Fashions Along the South Shore
3:00 p.m. Facts & Fun
4:00 p.m. Sporty Trends
4:30 p.m. Entertainment
5:00 p.m. Closing draws

.....

Saturday

- 9:45 a.m. Opening & Welcome
10:00 a.m. Fashions from the Rose City,
Windsor
11:00 a.m. Facts & Fun
11:30 a.m. Fun with Furs
12:00 p.m. Entertainment
1:00 p.m. Sporty Clothes
1:30 p.m. Facts & Fun
2:00 p.m. Fashions from the Rose City,
Windsor
3:00 p.m. Facts & Fun
4:00 p.m. Colours & Fashions
4:30 p.m. Sew & Sew
5:00 p.m. Closing draws

.....

Arts & Crafts

- The Arts and Crafts Area will be open daily from 9:30 a.m. to 5:00 p.m. Features will include quilt demonstrations. The winning entries from the Quilt Show will be featured in this exhibit. Official souvenirs of the Match are also available here.

Child Care

- The "Just for Children" child care centre, located adjacent to the Family Focus tents, is available daily for children 2 1/2 years (toilet trained) to 7 years and is sponsored by Family Focus and the Ministry of Community and Social Services. This area will provide a comfort station for parents to feed and change babies. It will also care for lost children.

International Plowing Match and Farm Machinery Show

- The International Plowing Match and Farm Machinery Show is one of the premier agricultural showcases in North America. It attracts some of the best plowmen from across the province and is one of the largest farm machinery shows on the continent.
- The Ontario Plowmen's Association, in cooperation with the many county plowmen's associations in the province, has sponsored the International Plowing Match and Farm Machinery Show since 1913. The Match is held annually in a different Ontario county and attracts more than 150 competitors. This year, the plowmen will be competing for more than \$35,000 in prize money.
- This year's Match site is located on Hi-Way Farms Inc. owned and operated by Richard Pogue and Frank Little as well as neighboring farms in the most southern county of the province. Approximately 800 acres have been set aside for the competition fields, the demonstration area and the Tented City.
- Over 600 exhibits feature the latest in farm machinery, seeds, chemicals, services and new technology. There are also parades, exhibits, and demonstrations of the latest in cars, appliances, houses and consumer products.
- The Tented City houses more than 50 caterers who will cook mountains of food to satisfy thousands of hungry visitors. They will provide everything from hot dogs or hamburgers to full-course homemade meals.

Essex Agriculture

- Well known as the "Sun Parlour of Canada", Essex County, Ontario is probably the most intensive and diversified cash crop farming area in Canada. The annual farm value of field, fruit, vegetable and greenhouse crops and livestock produced in the county has been more than \$200 million for several years.
- Essex is the most southern county in Canada. It extends below the 42nd parallel, which forms the northern boundary of the State of California. With the exception of a few gravel ridges, the topography of the county is very flat. There are many soil types in Essex County ranging from heavy clays to light sands.
- The largest area of clay soils around McGregor, Oldcastle, Essex, Woodslee, Belle River, Staples and Comber, produces excellent crops of grain corn, soybeans and winter wheat. In contrast, a smaller area of light textured soils which includes the Leamington, Kingsville and Harrow districts is well adapted for the production of horticultural crops such as tomatoes, potatoes, cabbage, cucumbers, peppers, apples, peaches and grapes. There is also an area of muck soils south of Leamington on Point Pelee where onions, carrots and other vegetables are grown.
- Leamington is the largest and most intensive greenhouse vegetable growing area in Canada with about 300 acres under glass or plastic. This represents about half of the total greenhouse area in the province of Ontario. Essex County greenhouses produce tomatoes, cucumbers and flowers such as mums and roses. The total of all Essex greenhouse crops is valued at more than \$60 million.

- We cannot overlook the value of Essex County's \$20 million livestock, milk and poultry output. Nearly 350,000 acres of farm land provide the base for this primary industry. The raw products provide hundreds of jobs at vegetable processing plants, vegetable packing sheds, distilleries, frozen food plants, grain elevators and wineries. Essex County is an important foodland area of Ontario.

Essex County — Breaking New Ground

- The location of Essex County as Canada's most southern land base and the fact that we are bordered by the United States on three sides gives this county a distinctly different character from the rest of Ontario.
- We are proud to be Ontarians and Canadians, however! The diversity of Essex County is shown in the heritage of its citizens who have come from many countries. Their traditions and culture have helped to make our county a great place to live.
- Practically every type of agriculture that is practiced in Ontario is found in Essex County, where there is a broad diversity of soil types and Ontario's longest growing season.
- No matter what your taste — wide open country or big city lights — Essex County can supply your needs. We are unique. We are Essex County!

Additional information on Essex

- Want to find out more about Essex County? Get a copy of the 1989 Visitor's Guide from Area Visitors and Convention Bureau, 80 Chatham St., Windsor N9A 2W1; or from various Travel & Tourist Information Centres in the City of Windsor and within the county. You can also learn more about Essex in the Essex County Tents at the Match.

Important Numbers

- General 519-767-3641 — Guelph
- Inquiries 519-776-7361 — Essex
- Billeting 519-733-5209
- Camping 519-969-7729
- Air Strip 519-966-5727
- Tours 519-723-4456

The Match Site

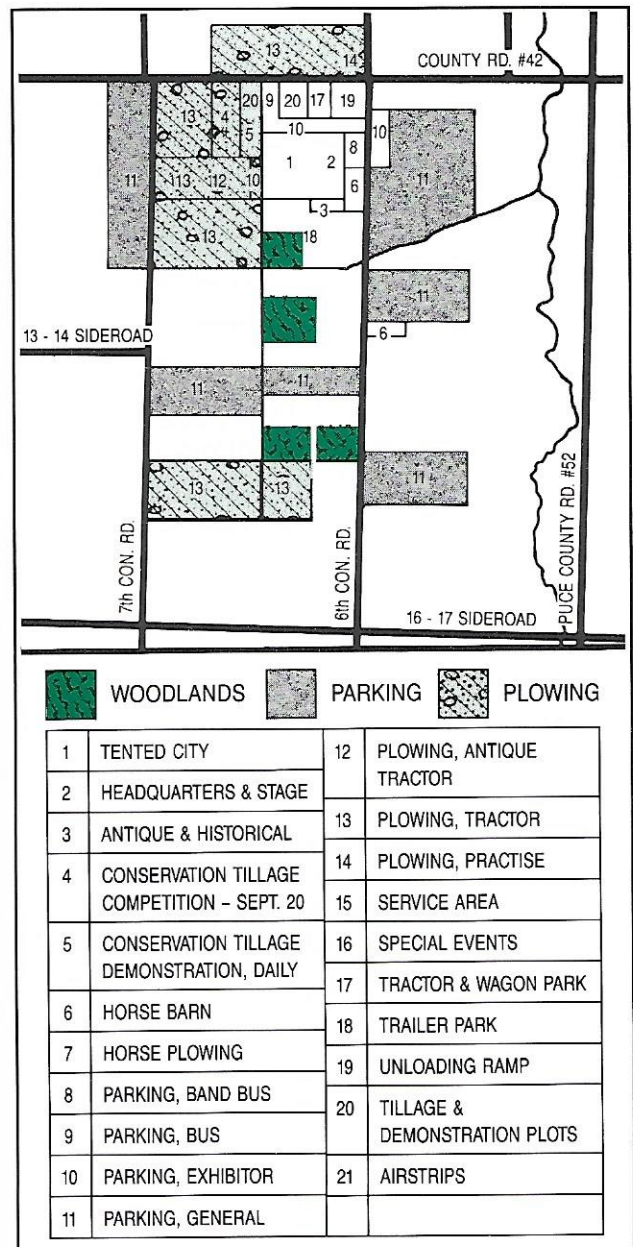

Some great new ideas are just around the corner.

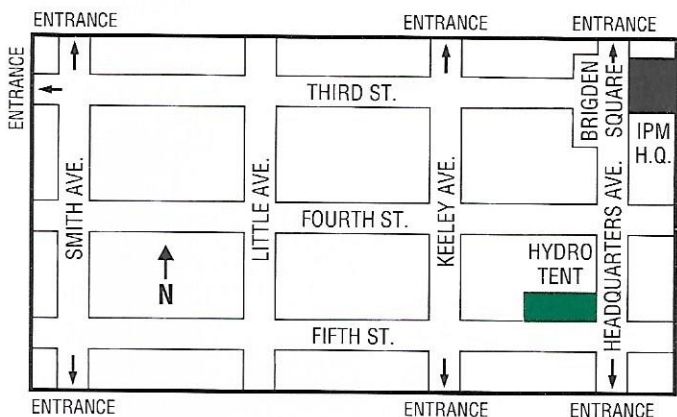

Drop in to the Ontario Hydro tent, at Headquarters Avenue and Fifth Street, and let's talk. We can discuss ways to manage your electricity bill by using more efficient lighting, heating and ventilation equipment. We'll show you our Energy Checklist, a simple and effective way for you to perform your own "energy audit". We can talk about nuclear power, transmission lines, electrical safety and inspections and rural retail customer services.

It's all in our tent.

So drop by for a chat. Because we're here to listen.



ontario hydro

a member of **EnerMark**
The Electricity People

Ces services sont également offerts en français.